

3/14/2022

To: Madison County Board of Supervisors

My name is Lela Davenport and I lived at 185 McDougal Road, Canton, MS, 39046. I had a house fire on January 7, 2022 in my manufactured home. I am asking for permission to replace the manufactured home with another one at this same address.

Sincerely,

Lela Davenport

WARRANTY DEED

For a valuable consideration cash in hand paid the undersigned by the grantees herein, the receipt of which is hereby acknowledged, we PETER DAVENPORT and ROSIE F. DAVENPORT, husband and wife, do hereby convey and warrant to RICHARD DAVENPORT and LELA C. DAVENPORT, husband and wife, as joint tenants with full rights of survivorship, and not as tenants in common, the following described real estate lying, being and situated in Madison County, Mississippi, to wit:

A tract of land containing 1.0 acres more or less in the SW 1/4 of NE 1/4, Section 25, Township 8 North, Range 2 East, Madison County, Mississippi, and being more particularly described as from the southwest corner of the SW 1/4 of NE 1/4, said section 25, run thence North for 2.36 chains, to a point thence running South 89 degrees 40 minutes east for 13.40 chains to the Southwest Corner of lot being described, and from said point of beginning run thence North 88 degrees 30 minutes east for 3.88 chains, thence running North for 2.58 chains, thence running South 88 degrees 30 minutes west for 3.88 chains to the northwest corner of tract being described, thence running south for 2.58 chains to the point of beginning, and containing in all 1.0 acres more or less and all being situated in the SW 1/4 of NE 1/4, Section 25, Township 8 North, Range 2 East, Madison County, Mississippi. ALSO 30 foot right-of-way easement to public road, which public road lies east of the above described land.

WITNESS our signatures, this the 2<sup>nd</sup> day of

March, 1989.

*Peter Davenport*  
PETER DAVENPORT

*Rosie Davenport*  
ROSIE F. DAVENPORT

STATE OF MISSISSIPPI  
COUNTY OF MADISON

PERSONALLY appeared before me, the undersigned authority in and for said County and State, the within named PETER DAVENPORT and ROSIE F. DAVENPORT, who each acknowledged that they signed and delivered the foregoing instrument on the day and year therein mentioned, as their act and deed.

GIVEN under my hand and official seal, this the 2<sup>nd</sup> day of March, 1989.

*Nannie La Morgan*  
NOTARY PUBLIC

My commission expires: 3/27/92

GRANTORS  
Peter Davenport  
Rosie F. Davenport  
P.O. Box 181  
Tougaloo, Ma 39174  
956-8874

GRANTEES  
Richard Davenport  
Lela C. Davenport  
Rt. 3 Box 120  
McDougal Rd.  
Canton, MS 39046  
856-7930



STATE OF MISSISSIPPI, County of Madison:

I certify that the within instrument was filed for record in my office this 2 day of March, 1989, at 4:30 o'clock P.M., and was duly recorded on the MAR 02 1989, Book No. 250, Page 417.

BILLY V. COOPER, CHANCERY CLERK BY: *[Signature]* D.C.

# Permit/Recommendation

This document is proof that a Notice of Intent has been filed as per  
Section 41-67-5, Mississippi Code of 1972, Annotated

The Mississippi State Department of Health has examined the soil and terrain of the property indicated below. The following recommendations are made using soil and site analysis principles and our best efforts. The Mississippi State Department of Health makes no warranty or representation as to any wastewater system installed. Recommendations may be voided if grading or fill changes the soil characteristics or if plat (dwelling or private water well) is changed and/or relocated.  
If you have any questions about your Permit/Recommendation, please contact the environmentalist of record. Current Certified Installers can be verified from [www.healthynms.com/wastewater](http://www.healthynms.com/wastewater) or verified by environmentalists.

Applicant:	Property:	Soil and Site Evaluation:
Lela Davenport 185 McDougal Road Canton MS 39046	185 McDougal Road Canton 39046 Section: Township: Range: Subdivision Name Lot Number: Lot Size: 1.00 Acres 0 sq. ft.	Slope: 1.00 %      Soil Textures: Top Soil: Silt Loam Sub Soil: Silt Loam Seasonal High Water 6 Inches Restriction 6 Inches Sensitive Water No

Application:	Water Supplier:	Soil and Site Evaluation:
Type of Residence Estimated Usage: 390 GPD Application Type: Notice Of Intent (Residential) + Final Approval (\$197.50)	Drinking Public	ID: 270412/215258 Date Issued: 2/7/2022 Expiration Date: 2/7/2024 Non-transferrable, valid for one (1) year from date issued. Notice of Intent filed: 1/26/2022

GPD = Gallons Per Day      N/A = Not Available      H = Horizontal      T = Triangular

Treatment:			
Septic Tank (with baffles):	N/A	Septic Tank (without baffles):	N/A
		Advanced Treatment System (ATS):	400 GPD

Disposal:		
Maximum Depth	N/A	Backfill Required : 12 inches minimum above the top of aggregate or prod

### Aggregate (Gravel/Tire Chips) Options

Trench (2 ft wide)	N/A	Trench (3 ft wide)	N/A	Absorption Bed	N/A
--------------------	-----	--------------------	-----	----------------	-----

### Aggregate Replacement Options

Large Diameter Pipe		Chambers			
Double 6 inch	N/A	Total Coverage Area Required		N/A	
8 inch	N/A	Linear Footage Required for Selected Chamber Widths			
10 inch	N/A	16":	N/A	22":	N/A
				34":	N/A

Expanded Polystyrene System (EPS)				Multi-Pipe System (MPS)			
3-10H:	N/A	1-12H:	N/A	MPS - 9	N/A	MPS 3609	N/A
		2-12H:	N/A	MPS - 11	N/A	MPS 3611	N/A
3-10T:	N/A	3-12H:	N/A	MPS - 13	N/A	MPS 3613	N/A
				MPS - 14	N/A		

ATS Specific Disposal Options				Additional Disposal Options			
Drip Irrigation	N/A	Backfill Require	N/A	Elevated Sand Mound			
Spray Irrigation	4161 Square Feet	Backfill Require	N/A	Basal	N/A		
Overland Discharge				Absorption	N/A		
1 Point	N/A						
2 Point	N/A						
4 Point	N/A						

**General Placement/Location of Soil Boring(s):**

Grid area for drawing or notes.

**Notes:**

**Author:** LAKEISHA PAIGE

Spray irrigation disposal system requires 3 - 30 foot radius spray heads at 180 degrees. Shed may need to be removed prior to wastewater disposal installation.

Recommendation is based on plot plan submitted by applicant any deviations in measurements will result in the recommendation being voided.

**Next Steps:**

Please make several copies of this document (Permit/Recommendation), and supply to the following if applicable:

- \* Public utility supplying water, to receive a water meter
- \* Certified well driller, if water source is from a private well
- \* County Code Office (Planning Department), placement/building permit
- \* Certified Installer, for installation

**REMINDER:** Approval of the design, construction or installation of an Individual On-site Wastewater Disposal System by the Department is required. The Certified Installer is responsible for notifying the Department 24-hours before beginning installation of your Individual On-site Wastewater Disposal System and, at that time, to schedule a time for inspection of the system with the Department.

After the inspection, you must provide the Department with the following to obtain Final Approval:

- \* Affidavit - Installation (From the Certified Installer)
- \* Affidavit - Maintenance (From you, if an Advanced Treatment System was installed)
- \* An additional fee of \$97.50 may be required for Final Approval, if not paid with initial application (Please see "Application" box on this form).

PLEASE BE AWARE, the Department cannot give Final Approval to any installation that occurs without inspection by the Department at the time of installation.

**REMINDER:** If any person or Certified Installer fails to obtain Final Approval or submit an Affidavit of proper installation to the Department in the installation of the system, the Department, after due notice and hearing, may levy an administrative fine not to exceed \$10,000.00. Also, if any person is operating in the state as an installer without certification by the Department, the Department, after due notice and opportunity for an administrative hearing, may impose a monetary penalty not to exceed \$10,000.00 for each violation as per Section 41-67-7(4) and 41-67-25(8) of the Mississippi Individual On-site Wastewater Disposal System Law.

**Environmentalist Signature:**

**Date:**

*Signature of Lakeisha Paige*

2/7/2022

Le LA Davenport  
185 Mc Dougal Rd.  
CANTON, MS 39046

PILOT PLAN

43,770 sq. FT.

Mobile Home  
101 x 91.5  
1216 sq. FT.

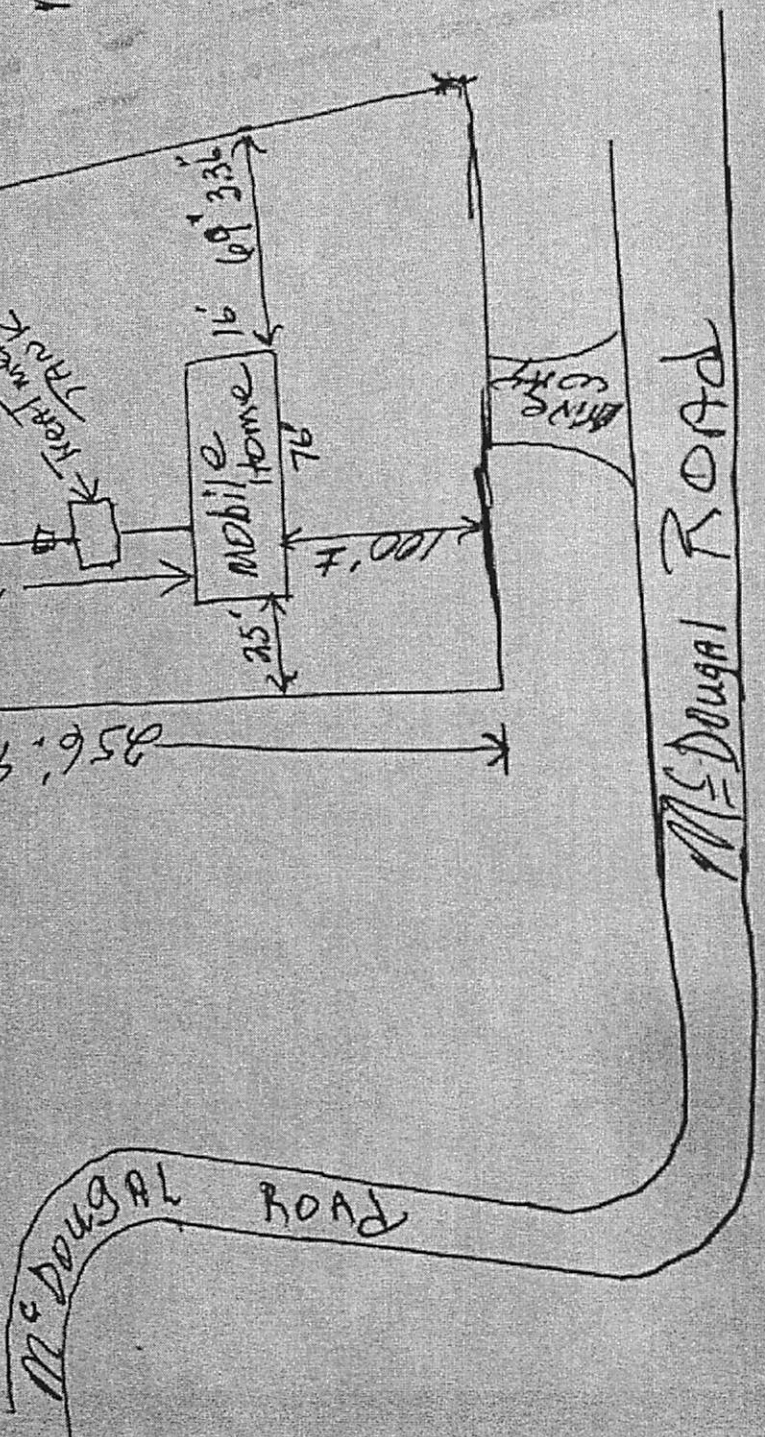
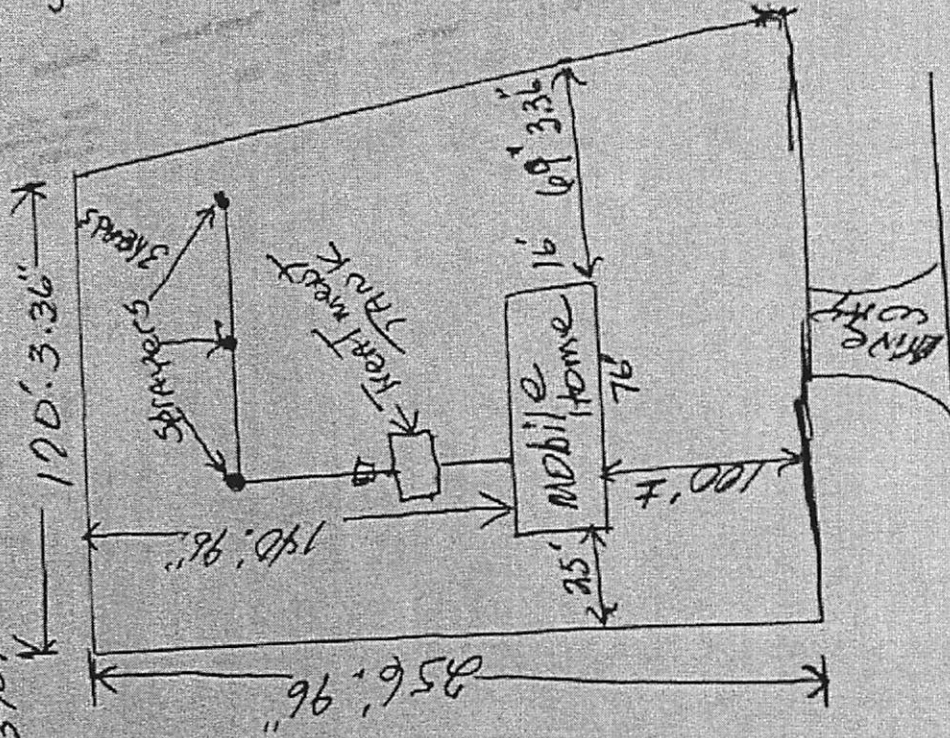

MONSON MS 39000